

CATERPILLAR LOCK WASHER 2H3922 NEW

Product Images

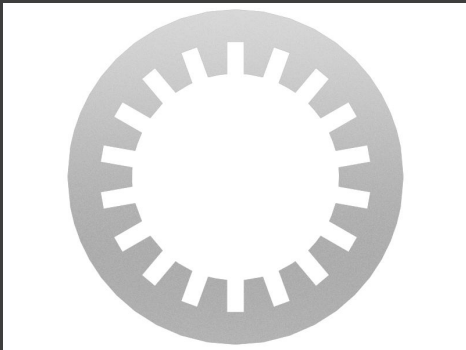
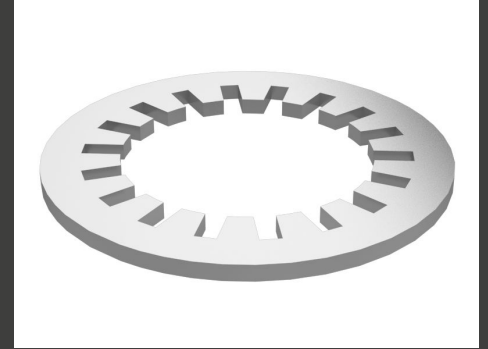

Description

Description:

Cat bolts and matching hardened washers and nuts form a matched system which produces consistently high clamp loads.

Attributes:

- Material: Steel
- Zinc plated
- For use with M18 or 3/4 inch hardware
- Outside diameter: 31.62 mm (1.244 in)
- Inside diameter: 19.53 mm (0.768 in)
- Thickness: 1.3 mm (0.051 in)

Additional Information

Brand

CATERPILLAR

Condition

ORIGINAL